

INSPECTION DOORS UNDER THE TILING

– MOUNTING PROCEDURE

RD-AL/S



Chráněno průmyslovým
vzorem společenství
Protected by industrial
design community



NOT TESTED FOR FIRE RESISTANCE

+



[A] SCREWS FOR PLASTERBOARD | [B] TURBO SCREWS | [C] SUCTION PAD | [D] PVC LATH | [E] HEX KEY



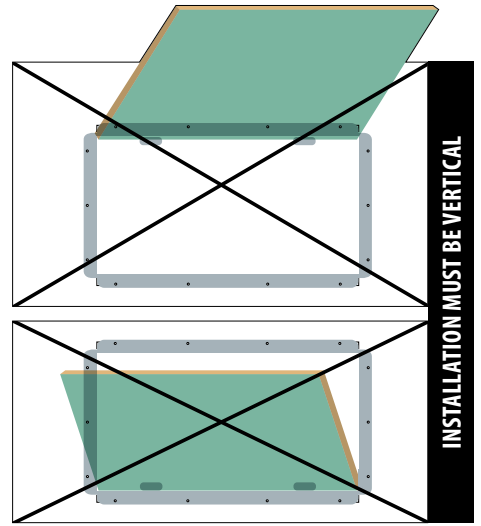
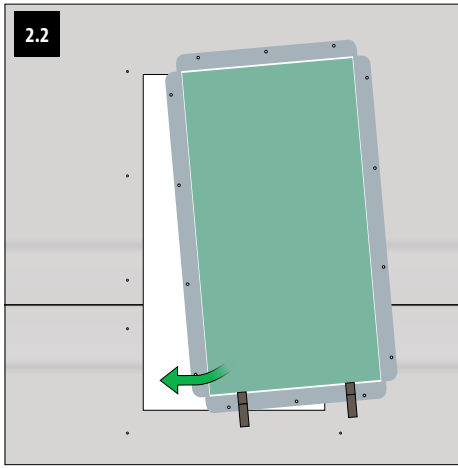
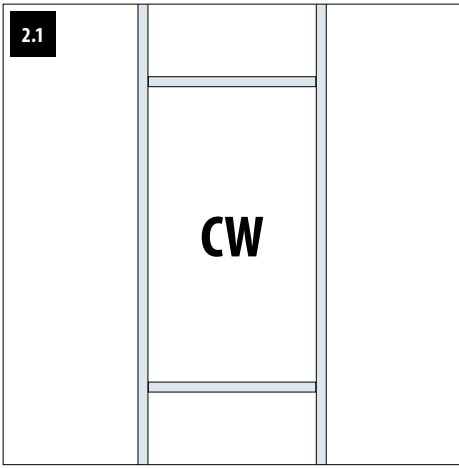

2.1	Grid – prepare the size of the mounting hole according to the Table of Sizes - T2.
2.2	Insert the doors.
2.3	Prepare the proper angle of the door frame.

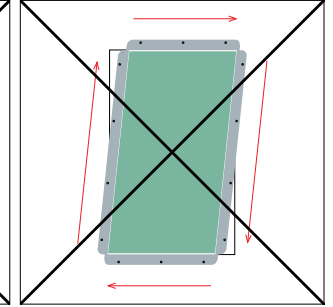
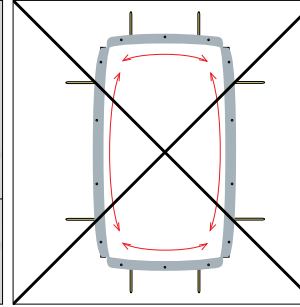
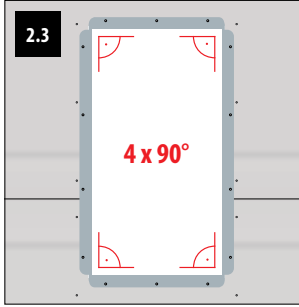

INSTALLATION IN DRYWALL

3.1	Install screws in the pre-prepared holes and secure the door frame [A] in the drywall. The screws must be screwed into the metal frames of the drywall partition!
-----	---

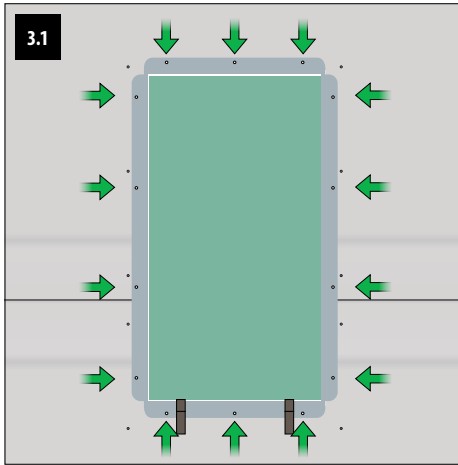

INSTALLATION IN SOLID MASONRY (E.G. YTONG)

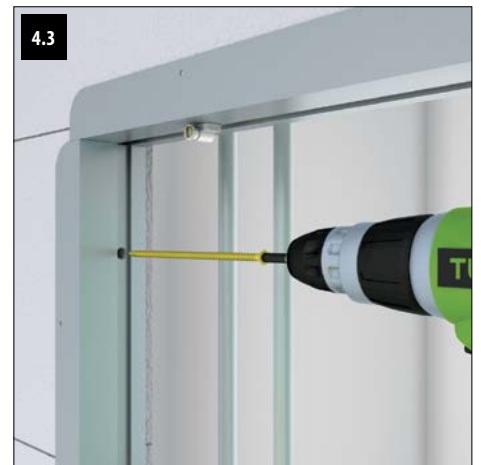
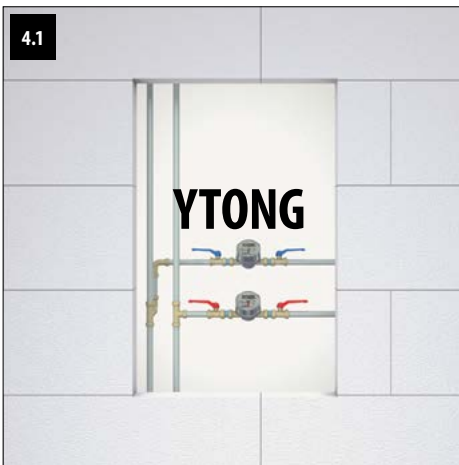

4.1	Prepare the size of the mounting hole according to the Table of Sizes – T2.
4.2	Insert the doors and prepare the angle Fig. (2.3).
4.3	Install turboscrews in the pre-prepared holes and secure the door frame [B].

TILING THE DOORS

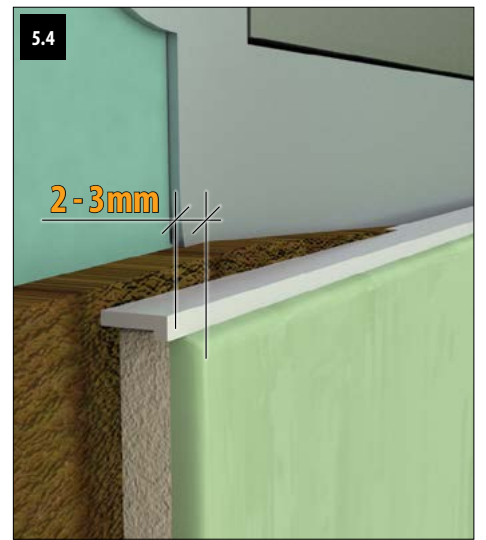
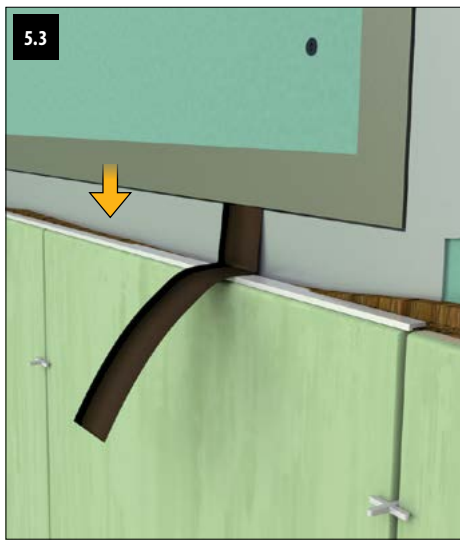
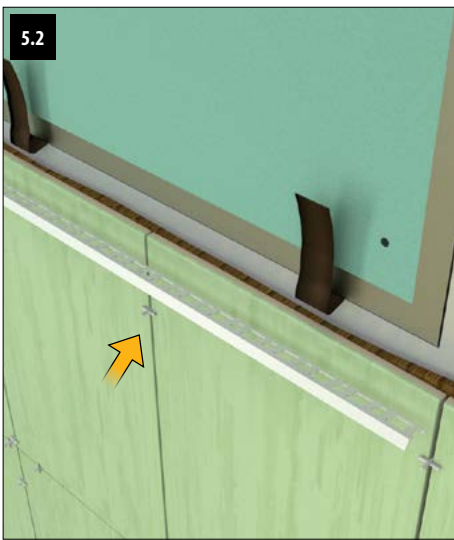
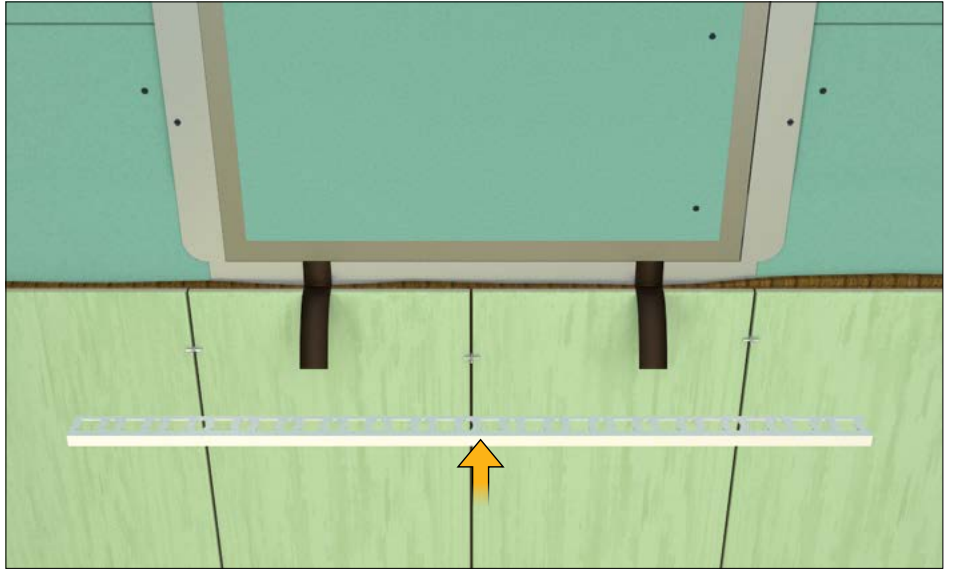

5.1-5.3	Penetrate the drywall. Use a quality flexible adhesive for bonding the tiles. Lay the tiling according to the Instructions for tiling the doors and figures (9.1), (9.2). (Always lay tiling at the door hinge!) Tile the bottom side and insert the PVC strip [D].
5.4	The ideal distance of the PVC strip [D] from the edge of the tiling is 2 - 3mm.

TILING

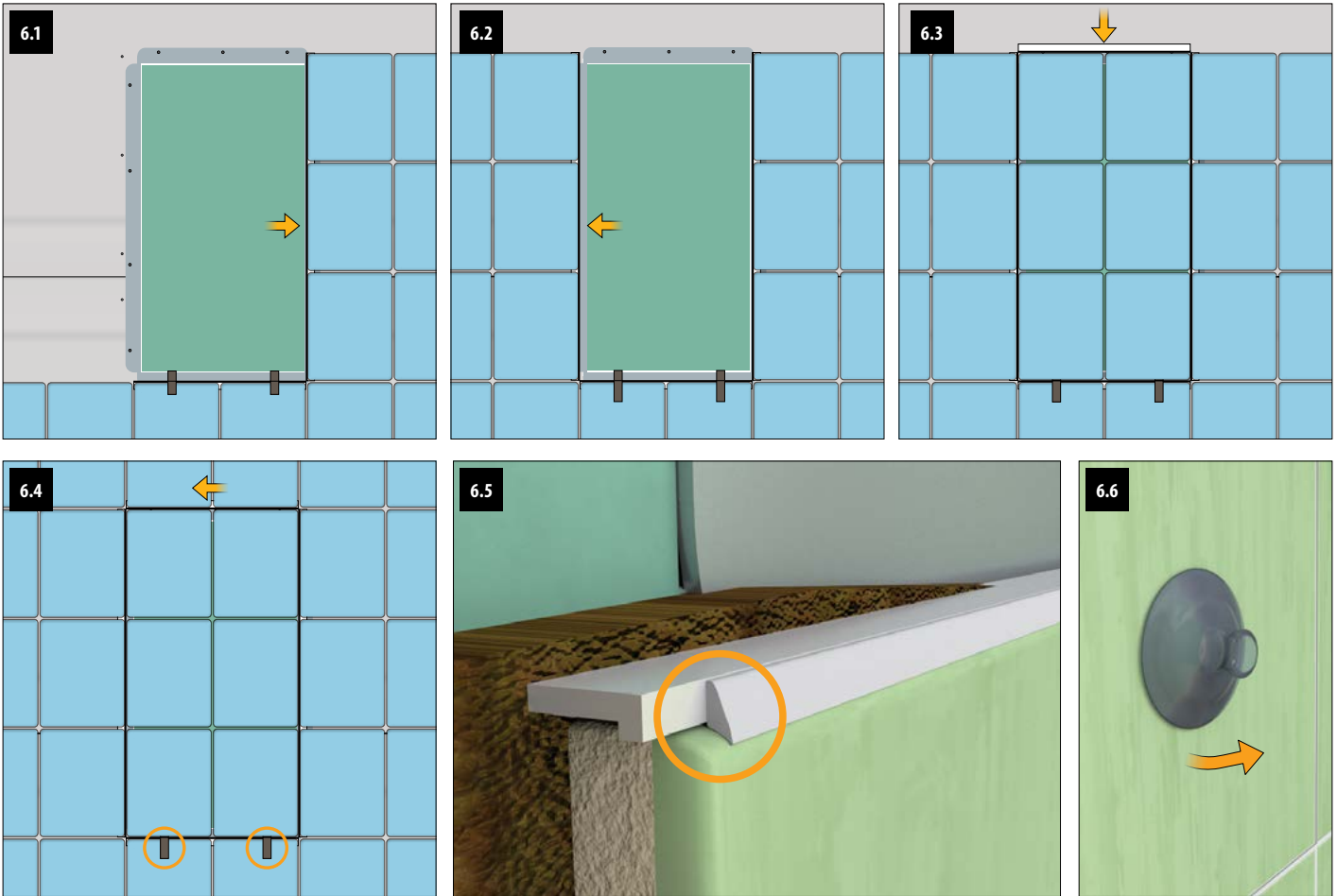

6.1	Tile the right side and insert the PVC strip [D].
6.2	Tile the left side and insert the PVC strip [D].
6.3	Before tiling the door, it is advisable to sand the outer and inner edges of the door tiling with abrasive cloth (not necessary for rectified tiles). After tiling the door, place the PVC tile edge trim [D] on the tiles.
6.4-6.5	Tile the upper side (make the tiles and PVC strips even) and let the glue harden. Use auxiliary tape for the first (direct) opening. Grout the space between the door in the open position and the surrounding tiling. After curing, finish grouting (hiding) the part where the PVC strip meets the edge of the tiling with silicone in the color of the grouting material.
6.6	After removing the auxiliary tape, open the door using a suction cup [C].

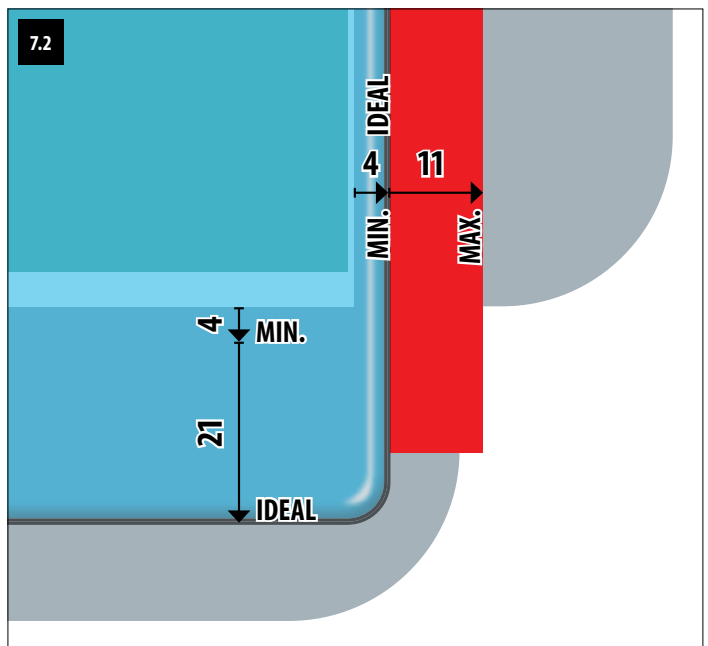
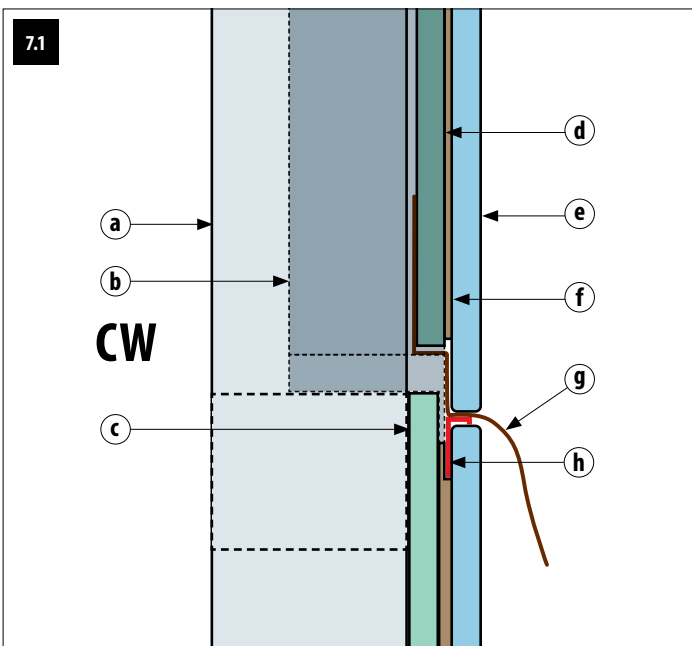

7.1	a) CW section.
	b) Aluminum door frame.
	c) Drywall secured to the CW section.
	d) Drywall door.
	e) Tiling.
	f) Flexible adhesive under the tiling.
	g) Auxiliary tape.
	h) PVC strip.

7.2	■ The maximum horizontal range on the side with the hinge is 15mm.
	■ The maximum vertical range is 40mm.

EXAMPLE OF UNHINGING AND INSTALLING THE DOORS



8.1-8.3 Loosen the body screws holding the upper dowel using an Allen wrench [E]. Slide the body out and secure with an Allen wrench. Unhinge the door.

8.3-8.1 Slide the dowel into the lower body. Release the upper body and slide onto the upper dowel. Tighten the screws.



TABLE OF SIZES

TYPE RD-AL/S	T1		T2		T3	
		(mm)		(mm)		(mm)
SIZE OF THE MOUNTING HOLE		400x600		400x590	3x	200x400
		400x750		400x740	6x	200x200
		400x800		400x790	6x	200x250
		500x660		500x650	3x	250x400
		500x800		500x790	4x	200x400
		500x900		500x890	4x	250x330
		500x990		500x980	4x	250x400
		600x600		600x590	4x	200x500
		600x750		600x740	4x	250x450
		600x800		600x790	6x	250x330
		600x900		600x890	2x	300x600
					3x	200x600
					9x	200x250
					3x	250x600
				6x	200x400	
				4x	200x600	
				3x	300x600	
				4x	300x450	

The possibility of producing atypical dimensions

The diagrams illustrate the following configurations:

- 3X (200x400mm):** Three tiles stacked vertically to form a 200x600 rectangle.
- 6X (200x200mm):** Six tiles in a 2x3 grid to form a 200x400 rectangle.
- 6X (200x250mm):** Six tiles in a 2x3 grid to form a 200x500 rectangle.
- 3X (250x400mm):** Three tiles stacked vertically to form a 250x600 rectangle.
- 4X (200x400mm):** Four tiles in a 2x2 grid to form a 200x400 square.
- 4X (250x330mm):** Four tiles in a 2x2 grid to form a 250x330 rectangle.
- 4X (250x400mm):** Four tiles in a 2x2 grid to form a 250x400 rectangle.
- 4X (200x500mm):** Four tiles in a 2x2 grid to form a 200x500 rectangle.
- 4X (250x450mm):** Four tiles in a 2x2 grid to form a 250x450 rectangle.
- 6X (250x330mm):** Six tiles in a 2x3 grid to form a 250x330 rectangle.
- 2X (300x600mm):** Two tiles stacked vertically to form a 300x600 rectangle.
- 3X (200x600mm):** Three tiles stacked vertically to form a 200x600 rectangle.
- 9X (200x250mm):** Nine tiles in a 3x3 grid to form a 200x250 rectangle.
- 3X (250x600mm):** Three tiles stacked vertically to form a 250x600 rectangle.
- 6X (200x400mm):** Six tiles in a 2x3 grid to form a 200x400 rectangle.
- 4X (200x600mm):** Four tiles stacked vertically to form a 200x600 rectangle.
- 3X (300x600mm):** Three tiles stacked vertically to form a 300x600 rectangle.
- 4X (300x450mm):** Four tiles in a 2x2 grid to form a 300x450 rectangle.

T1	T2	T3	
400x750	400x740	6x	200x250

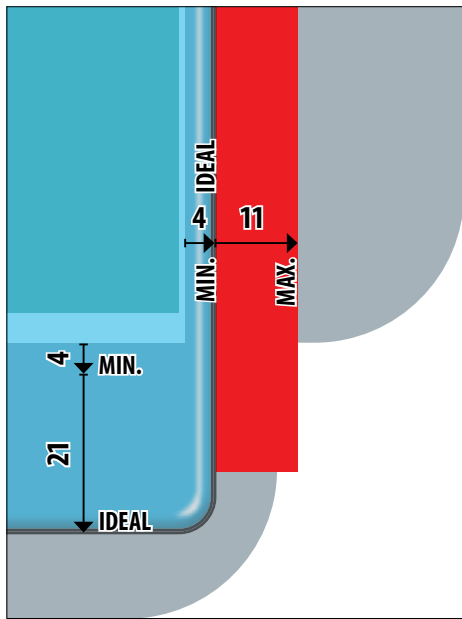
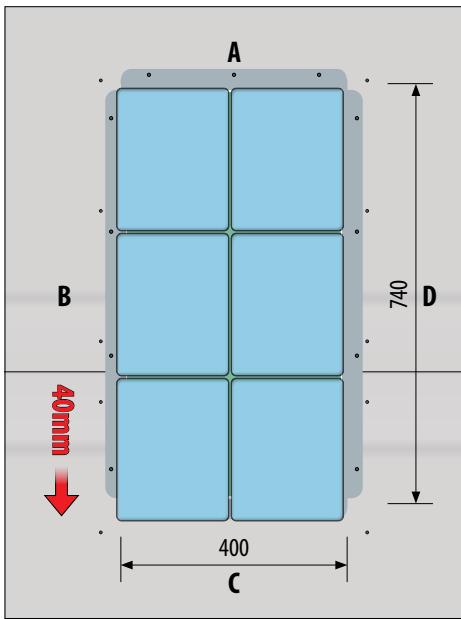
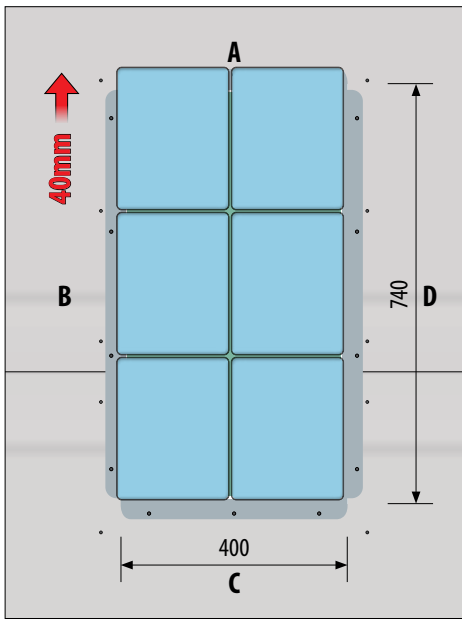
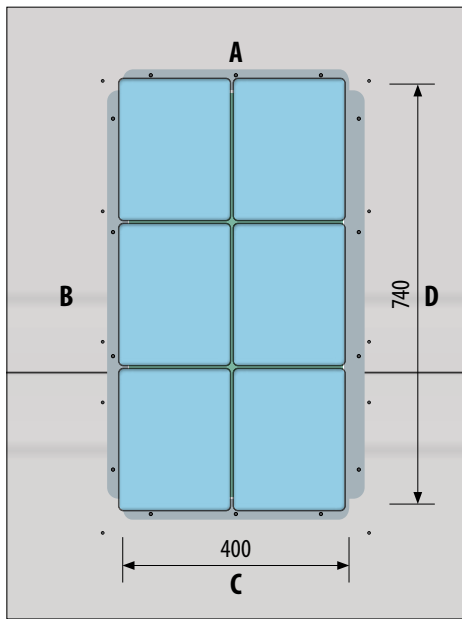
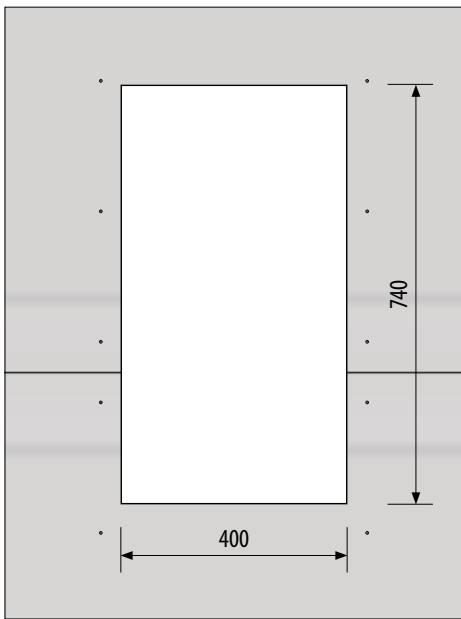
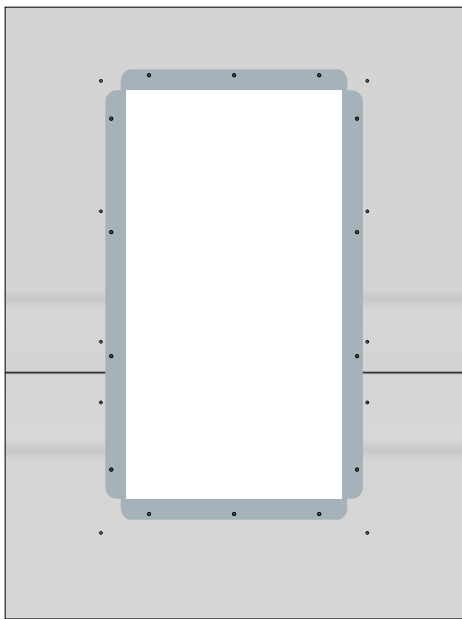

On sides **A**, **B**, **C** the tiling can liberally overlap the drywall of the doors. By just **15mm** on side **D** (at the hinge of the door).
 On sides **A** and **B** the dimensions of the frame make it possible to use a range in laying the tiling with a tolerance of **40mm**.